

Courses of the River and Creek From the Pinetree downwards.

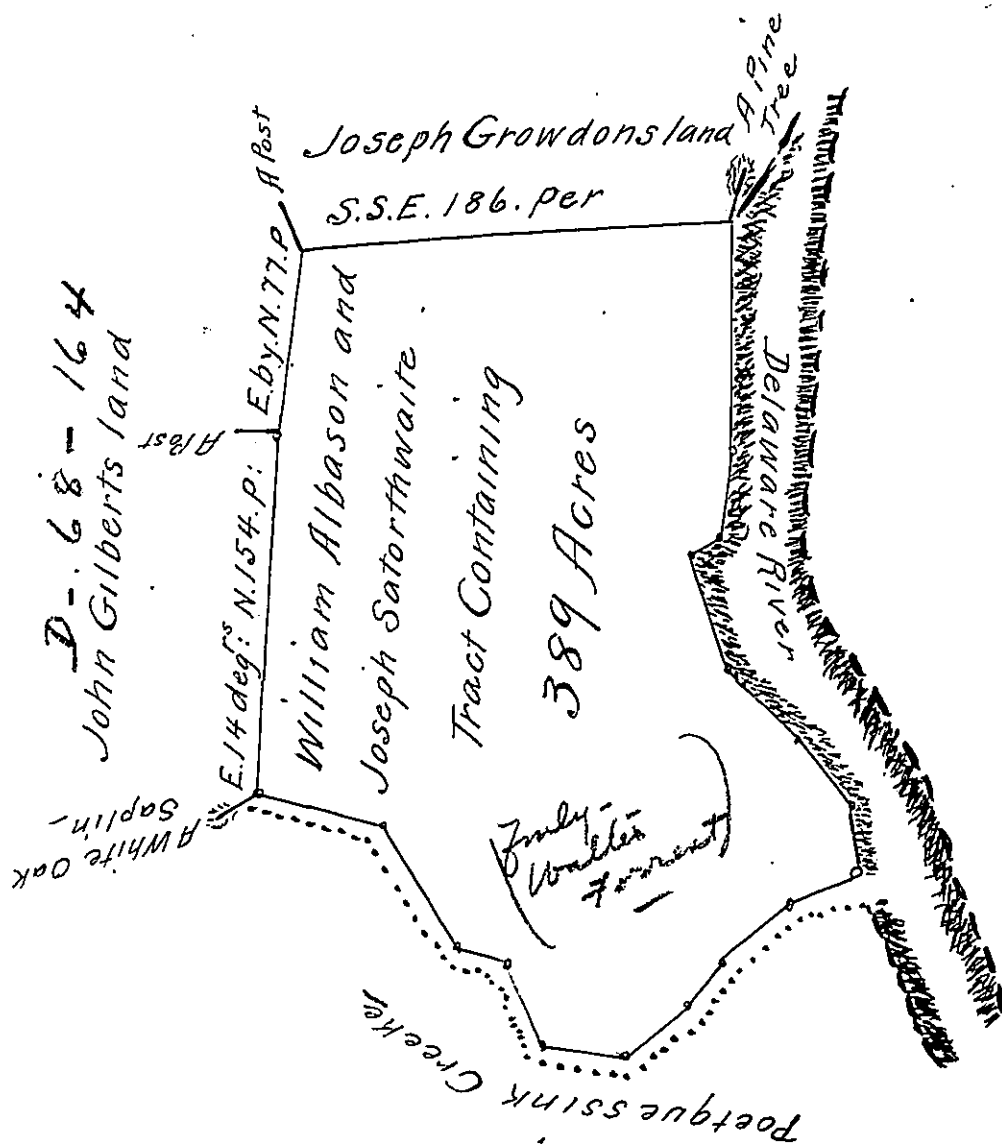

Angles With the Meridian degrs	Dist. in Perchs
S. 72. W.	96
S. 78. W.	36
N. 47. W.	14
S. 53. W.	46
S. 22. W.	42
S. 33. W.	36
S. 66. W.	30
N. 40. W.	32
N. 57. W.	38
N. 74. W.	22
N. 53. W.	34
N. 10. W.	36
N. 48. E.	39
North	23
N. 41. E.	64
N. 5. W.	55
N. 76. E.	154
E. by N.	77
S. S. E.	186

300
343

By virtue of a Warrant from the Commissioners of Property to me directed bearing date the 10th day of the 1st month 170 $\frac{1}{2}$ to execute all Warrts directed to Phineas Pemberton and not executed, And pursuant to a Warrt from the Said Comm^{rs} to the Said Phineas Pemberton dated the 21st of the 11th Month 1701. Resurveyed unto William Albason and Joseph Satorthwaite A Tract of Land in Bensalem in Bucks County formerly belonging to Walter fforrest, Beginning at A Pine tree by Delaware River being the Corner of Joseph Growdon's Land, Thence down the Several Courses of the Said River to the mouth of Poetquesink Creeke Thence up the Several Courses of the Said Creek to a Small White oak Saplin at the Corner of John Gilberts land, Thence by the Said land E. 14 deg^{rs}. N. 154. P. to a Post by the Road. Thence E by N. 77 per to a Post in Joseph Growdon's line, Then by the Same S.S.E 186 to the place of Beginning, Containing 389 Acres, Resurveyed the 28th day of the 1st month 170 $\frac{1}{2}$

By me John Cutler

IN TESTIMONY that the above is a copy of the original remaining on file in the Department of Internal Affairs of Pennsylvania, made conformably to an Act of Assembly approved the 16th day of February, 1833, I have hereunto set my Hand and caused the Seal of said Department to be affixed at Harrisburg, this 14th day of JUNE 1909

Henry Houck
Secretary of Internal Affairs.